



LIGHT-DUTY LEVELERS
WOOD SCREW GLIDES
CABINET FEET

Wood Screw Glides

IEC's *wood screw glides* shown here allow for easy sliding. They have a PTFE base with a black rubber cushion top. They can also use sheet metal screws and standard machine screws with or without a nut.



Wood Screw Glides

| P/N | Dia. | Base Height | Hole Size | Thread | 1-99 | 100-249 |
|-----------------|------|-------------|-----------|----------|-------|---------|
| IL25-SLDR-WOOD | 1 | 3/16 | 3/16 | #6 x 5/8 | \$.95 | \$.86 |
| IL27A-SLDR-WOOD | 2 | 1/4 | 3/16 | #6 x 5/8 | \$ | \$ |
| IL27F-SLDR-WOOD | 3 | 1/4 | 3/16 | #6 x 5/8 | \$ | \$ |



Wood Screw Felt Pad Glides

| P/N | Dia. | Felt Thick. | Color | 1-99 | 100-249 |
|------------------|-------|-------------|-------|-------|---------|
| IL20-2-FELT-WOOD | 3/4 | 3/8 | GREY | \$.86 | \$.76 |
| IL20-3-FELT-WOOD | 7/8 | 3/8 | GREY | \$.87 | \$.77 |
| IL20-4-FELT-WOOD | 1 | 3/8 | GREY | \$.88 | \$.78 |
| IL20-5-FELT-WOOD | 1-1/8 | 3/8 | GREY | \$.89 | \$.79 |

Cabinet Feet

38-Cabinet Feet Bumpers IEC *plastic cabinet feet* are ideal for light cabinets, tables and furniture. They attach to wood, metal or plastic. They are supplied with panhead wood screws.

39-Thermo-Plastic Rubber Feet/Bumpers IEC's *thermo-plastic rubber feet/bumpers*.

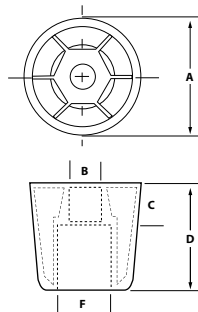

Pan Head Wood Screws (zinc-plated):

- A = #6 x 5/8"
- B = #8 x 5/8"
- C = #8 x 1"
- D = #10 x 3/4"
- E = #4 x 5/8"

38-Cabinet Feet

| P/N | A | B HOLE DIA. | C | D | E TAPER | F | USES SCREW | COLOR |
|------------------|-------|-------------|------|-----|---------|------|------------|-------|
| IL24-CAB-3/8 | 7/8 | 5/32 | 3/16 | 3/8 | 8 | 5/16 | B | BLACK |
| IL24-CAB-1/2 | 7/8 | 13/64 | 1/4 | 1/2 | 10 | 3/8 | B | BLACK |
| IL24-CAB-5/8 | 7/8 | 13/64 | 1/4 | 5/8 | 8 | 3/8 | B | BLACK |
| IL24-CAB-5/8-BRN | 7/8 | 13/64 | 1/4 | 5/8 | 8 | 3/8 | C | BROWN |
| IL25-CAB-3/4 | 1 | 13/64 | 3/8 | 3/4 | 8 | 3/8 | C | BLACK |
| IL25-CAB-3/4-BRN | 1 | 13/64 | 3/8 | 3/4 | 8 | 3/8 | D | BROWN |
| IL25A-CAB-1 | 1-1/8 | 1/4 | 3/8 | 1 | 6 | 1/2 | D | BLACK |
| IL25A-CAB-1-BRN | 1-1/8 | 1/4 | 3/8 | 1 | 6 | 1/2 | A | BROWN |

39-Thermo-Plastic Rubber Feet / Bumpers

| P/N | A | B HOLE DIA. | C | D | F | USES SCREW | COLOR |
|---------------|-----|-------------|-----|-----|-----|------------|-------|
| IL24D-CAB-RBR | 3/8 | 1/8 | .08 | .22 | .30 | E | BLACK |
| IL24C-CAB-RBR | 1/2 | .15 | .15 | .25 | .28 | A | BLACK |
| IL24A-CAB-RBR | 3/4 | .17 | .17 | .28 | .38 | B | BLACK |
| IL25-CAB-RBR | 1 | .18 | .18 | .31 | .60 | B | BLACK |